

Product specifications

Reference	V5-M8-STD	
Consumable	Pellet / Flakes	
	Diameter range	Ø1-4 mm
Screw	Material	Hardened steel
	Diameter	Ø8 mm
	Compression ratio	2:1
Barrel	Material	Brass
	Nozzle thread	M6
Nozzle	RepRap / E3D V6	0.8 mm
	Min-max	0.4-2 mm
Heating	CHC 24v 80w	6,5Ω ±10%
Thermistor	Ø3x15 mm	NTC 100k
Cooling Fan	Axial 4010	24v
Layer Fan	2x Blower 5015	24v
Motor	Ref:	17HS19-1684S-PG5
	Power	1.68 amps
	Ratio	5: 1
Flow	15-25 mm ³ /s	
Measurements	175 mm x 42 mm x 42 mm	
Weight	≈ 750g	

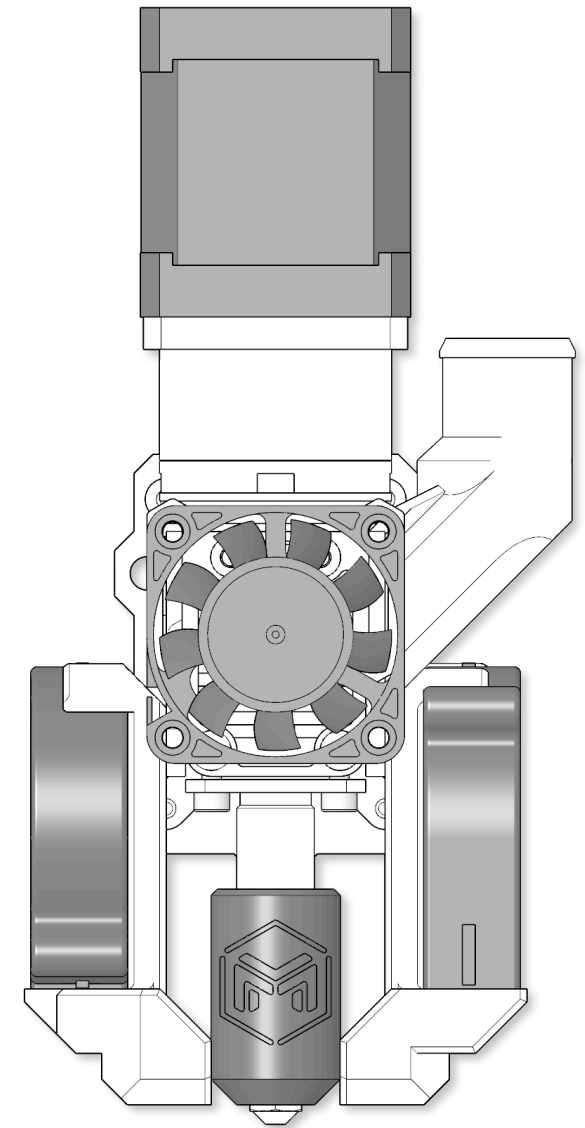

Dimensions

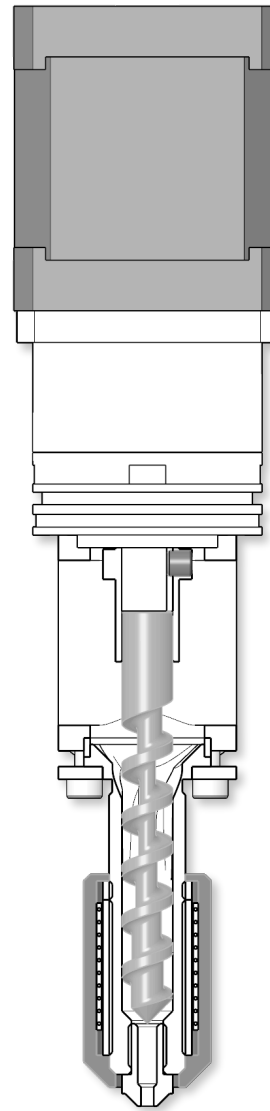
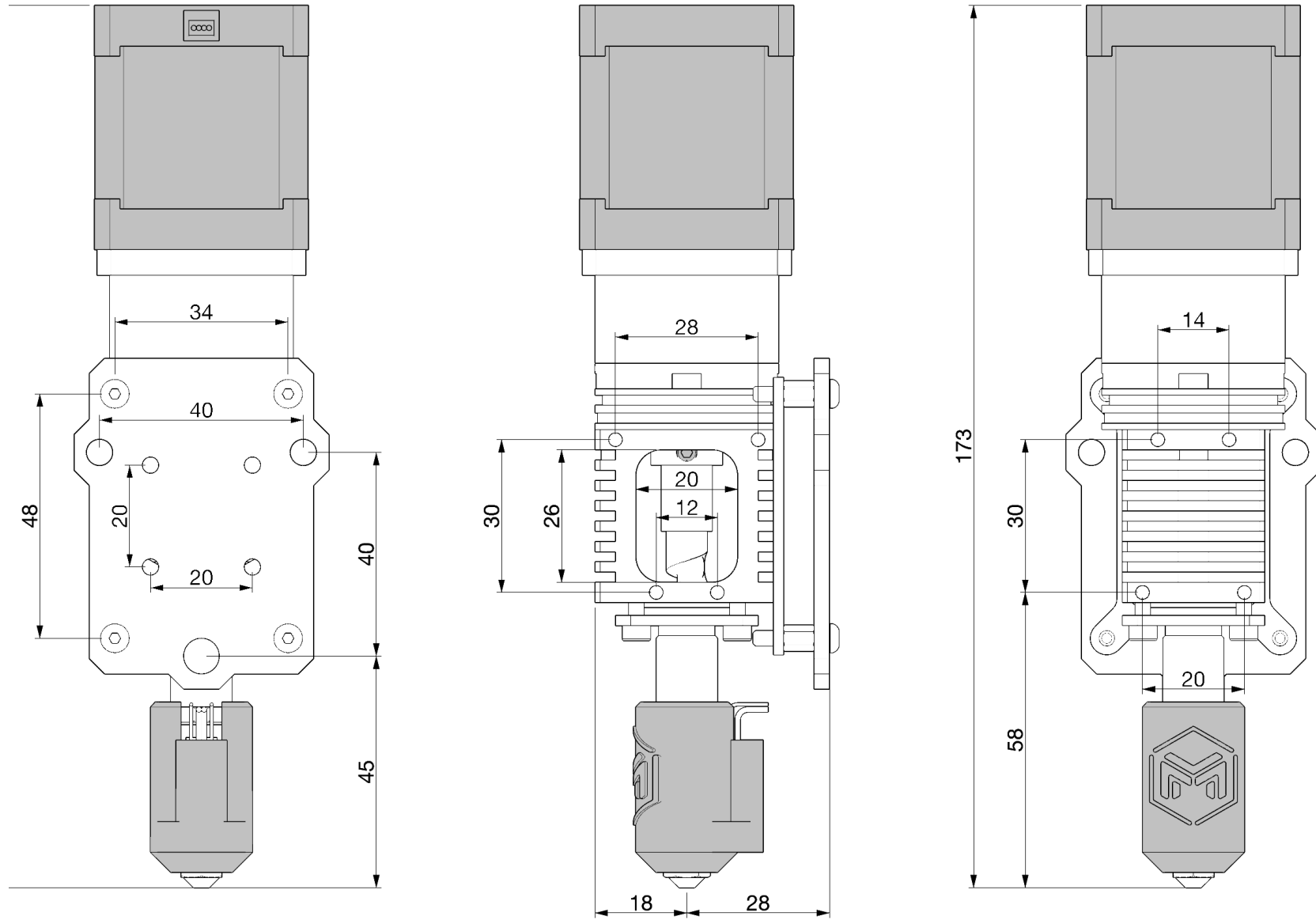

V5 Pellet Extruder

IAMTECH

CHC Ceramic Heating Core

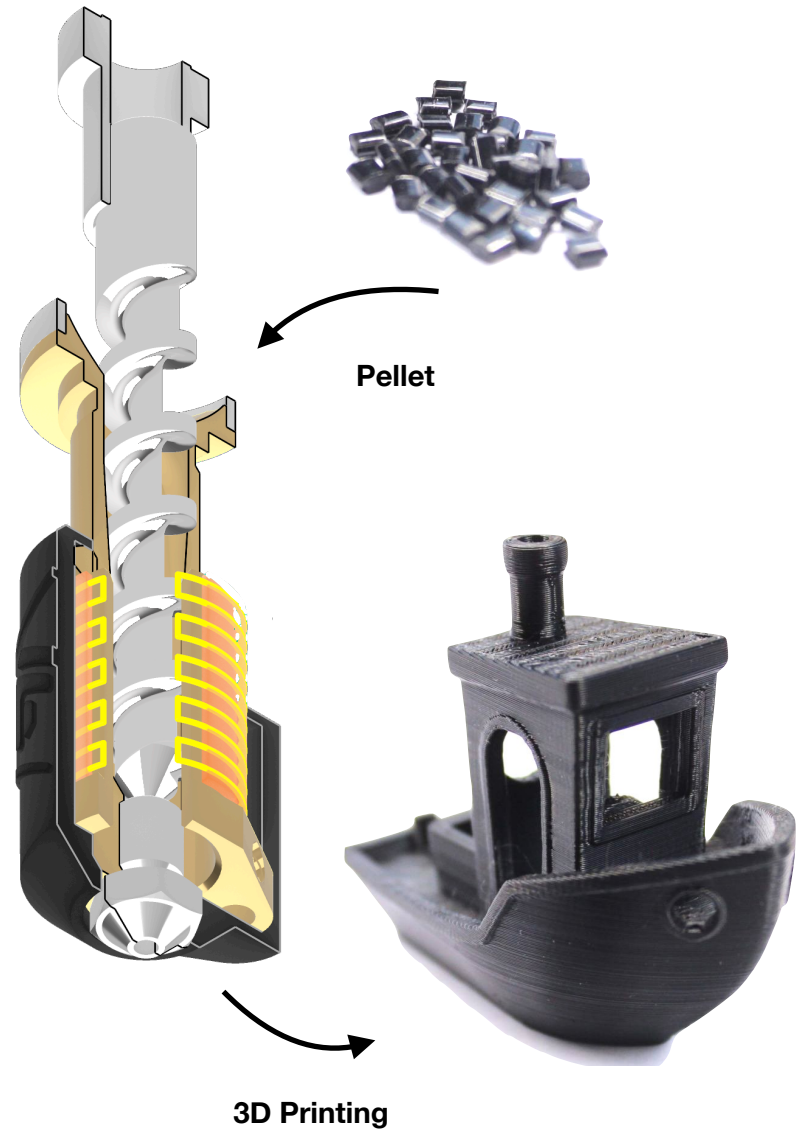
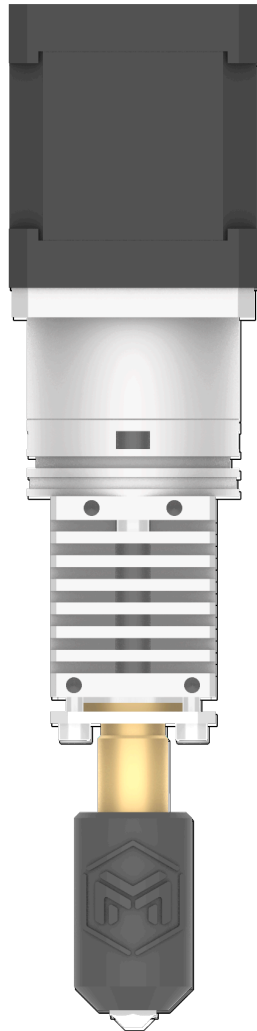
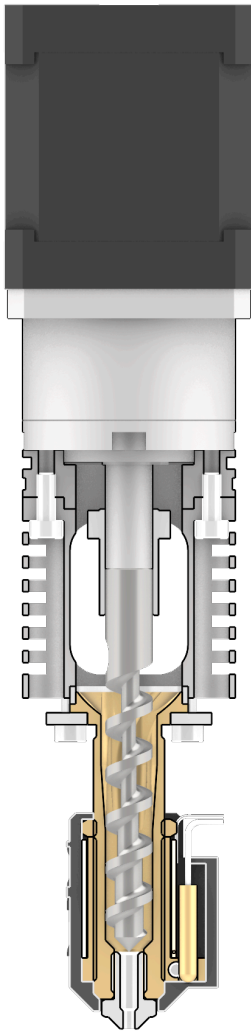

MAHOR·XYZ

V5 Pellet Extruder

IAMTECH

Over view

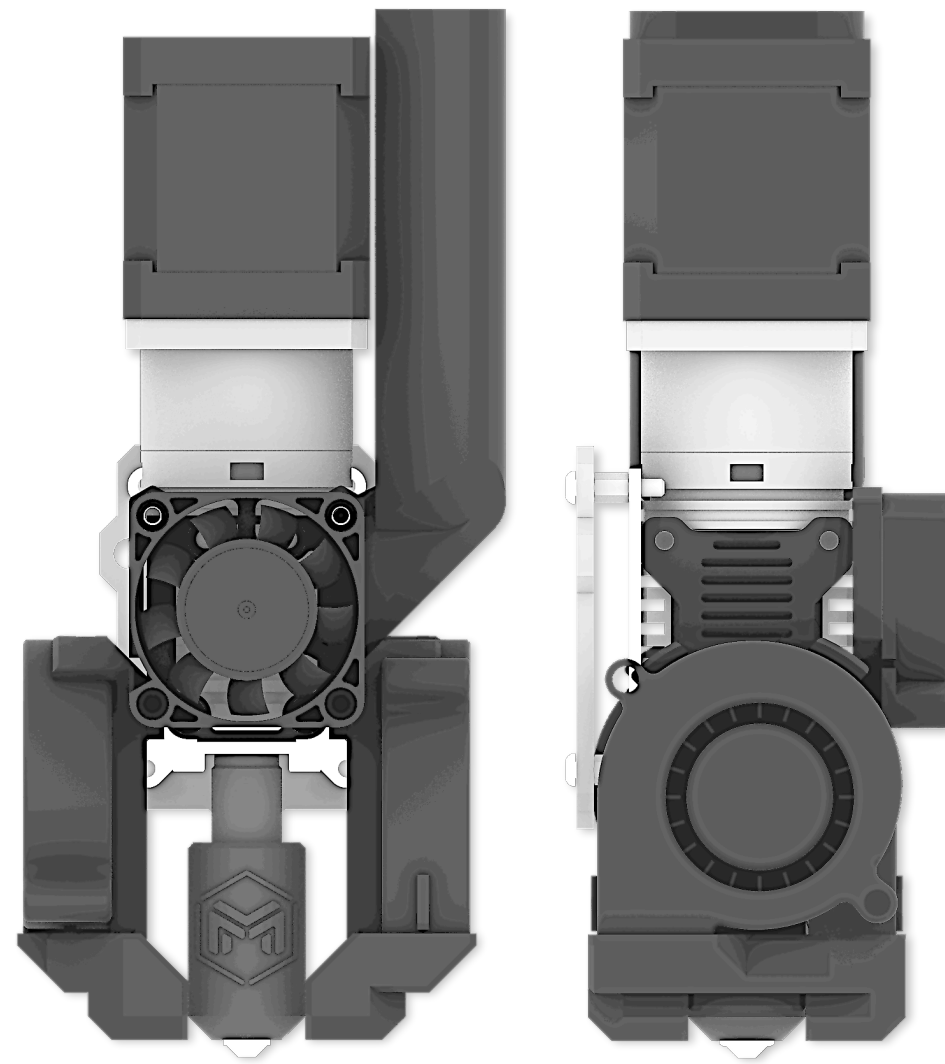
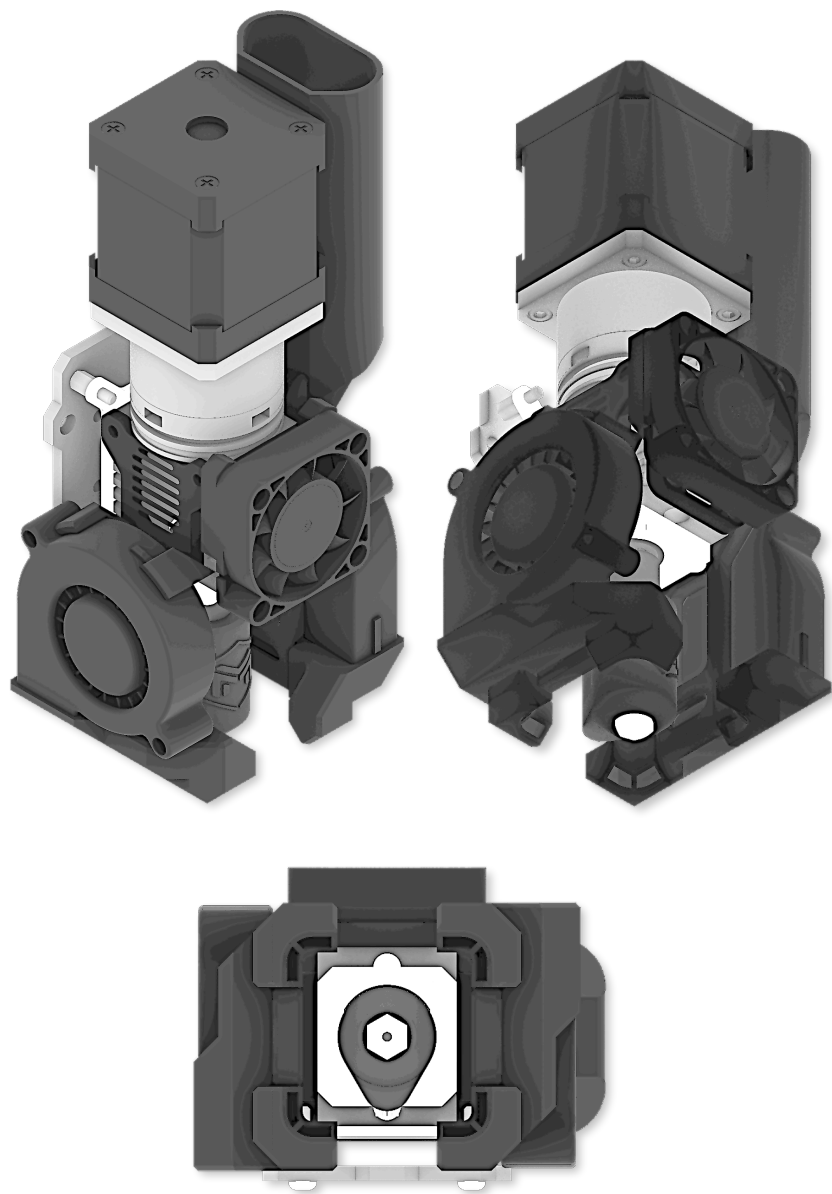

MAHOR·XYZ

Feeding

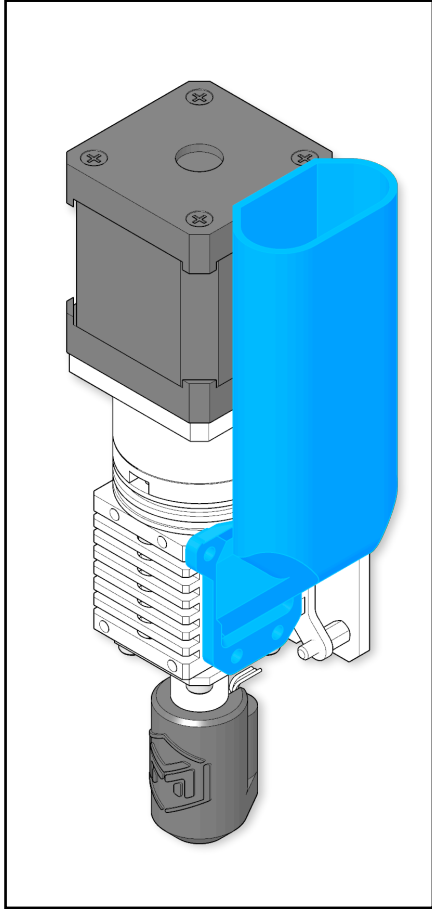

Direct

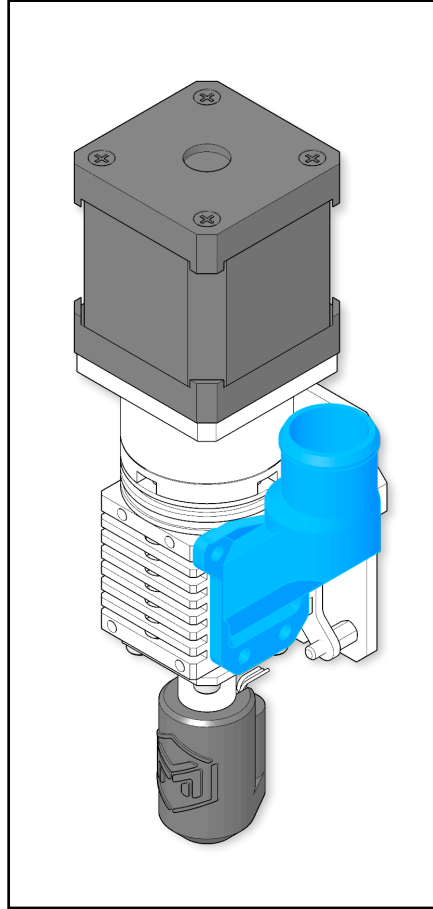

Ø20mm Tube connector

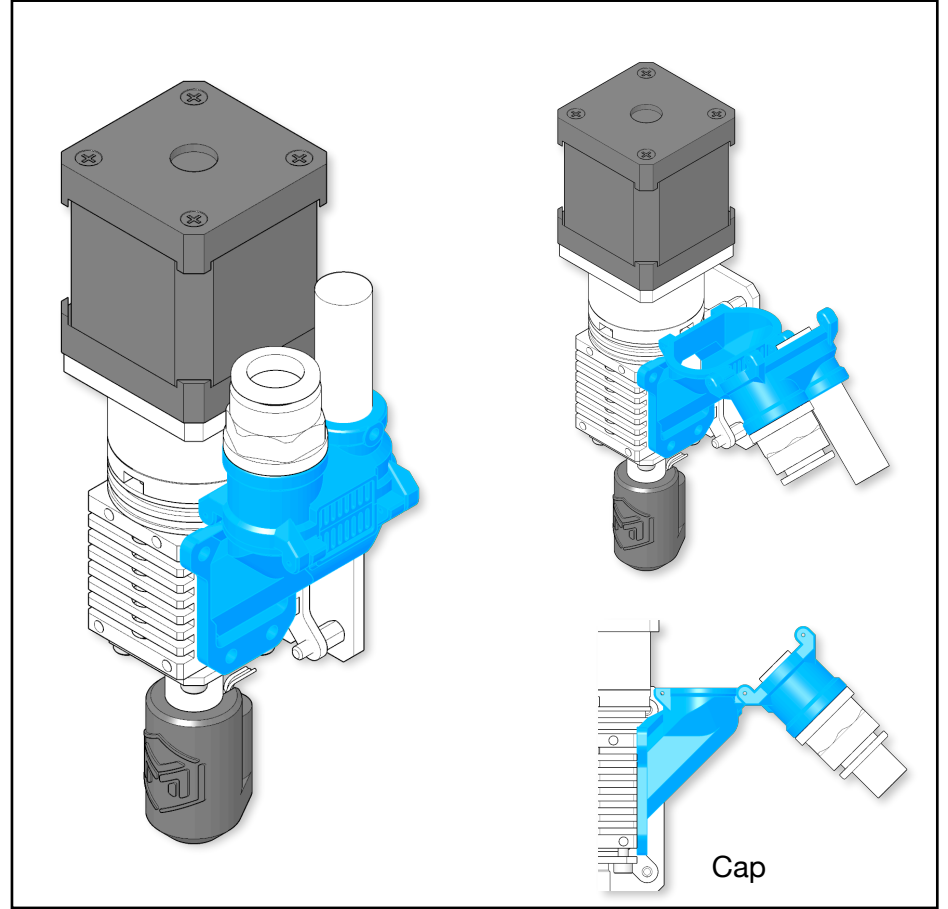

Automatic feeding

Cooling fan

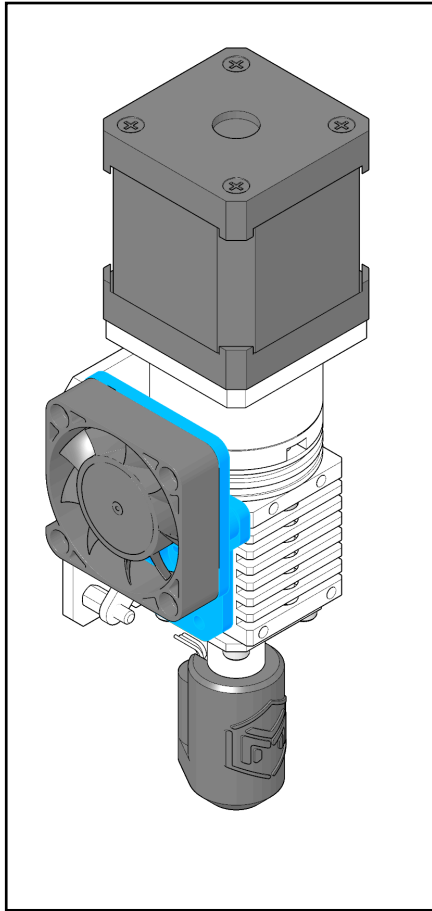

Direct 4010 fan

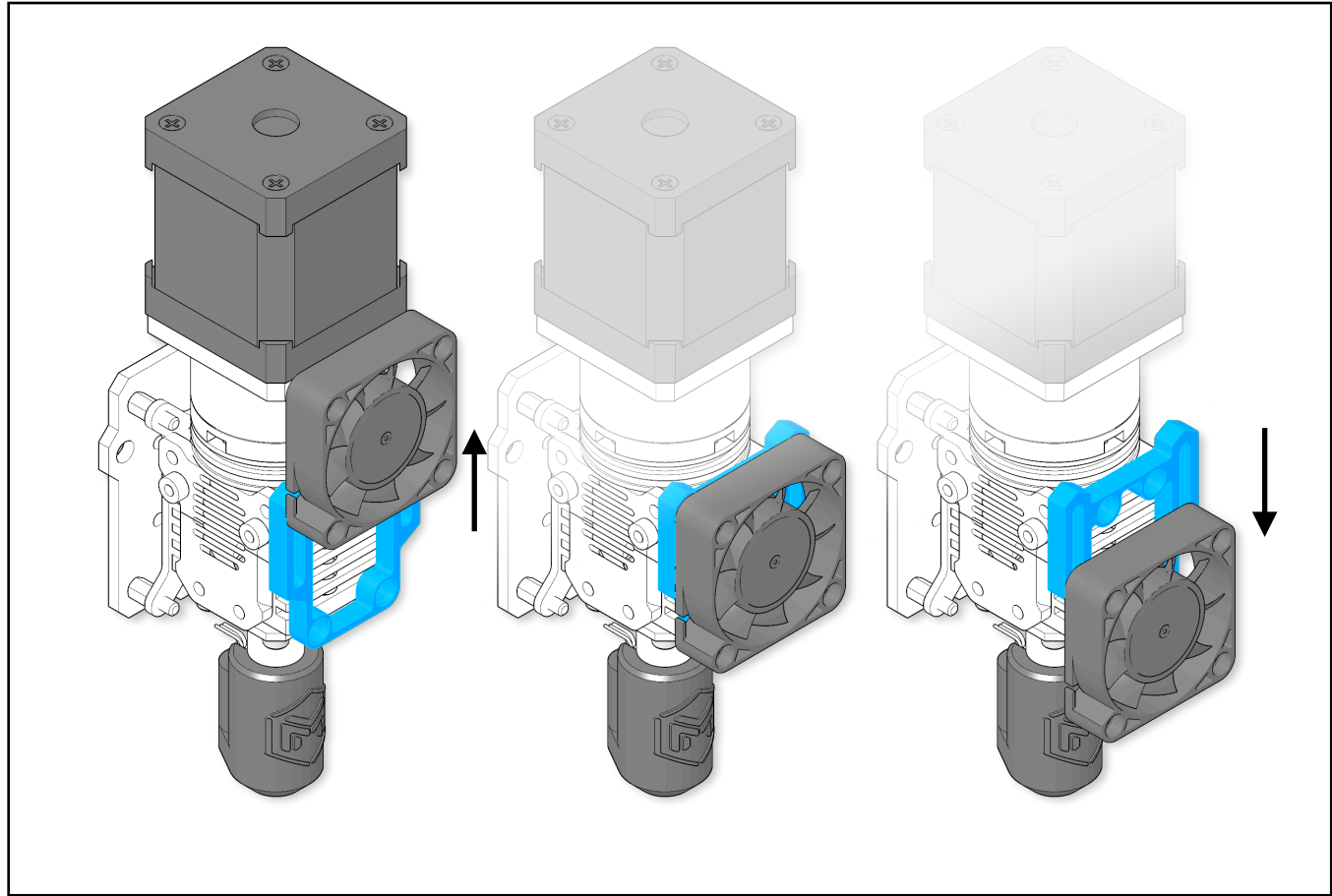

Adjustable indirect 4010 fan

Layer fan

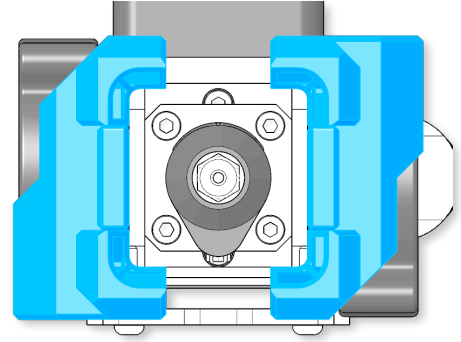
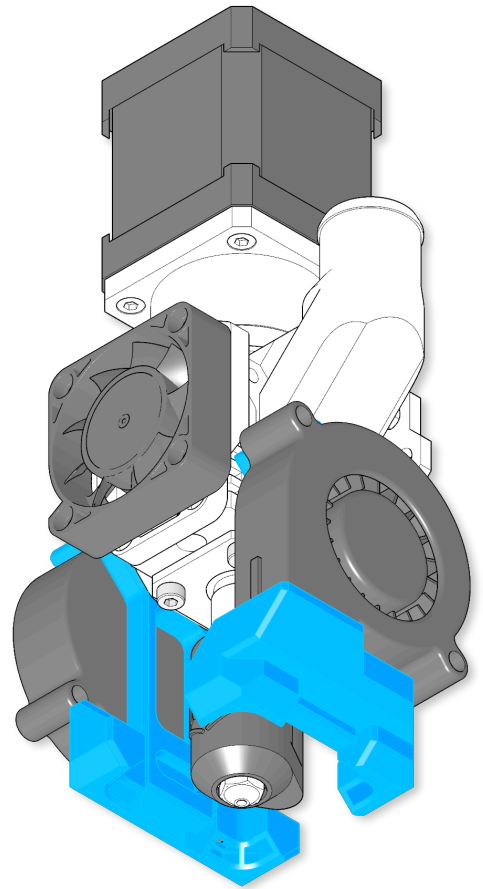

360° cooling

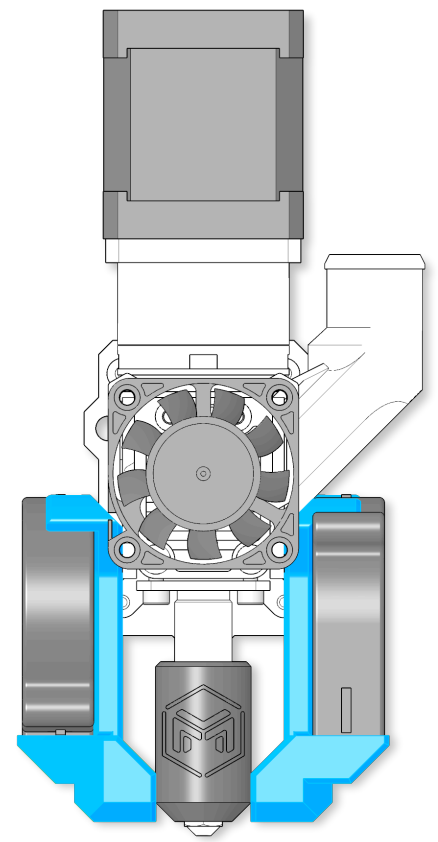
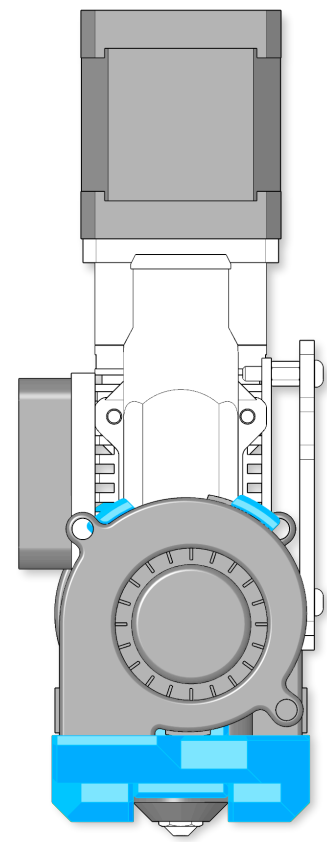
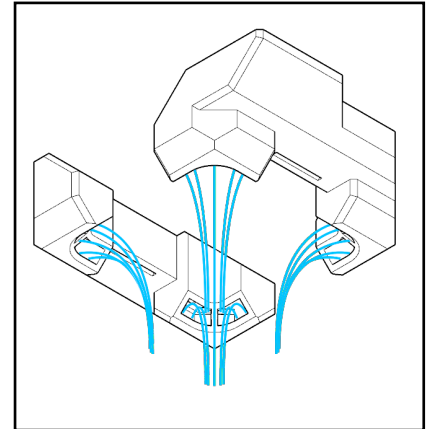

Extruder parts

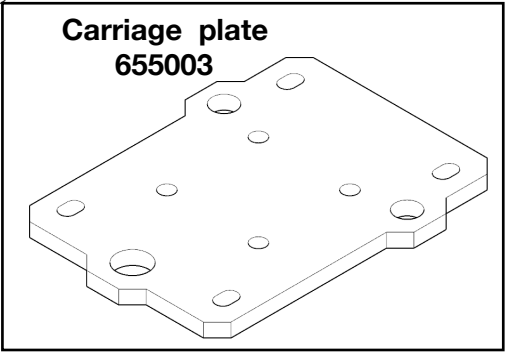
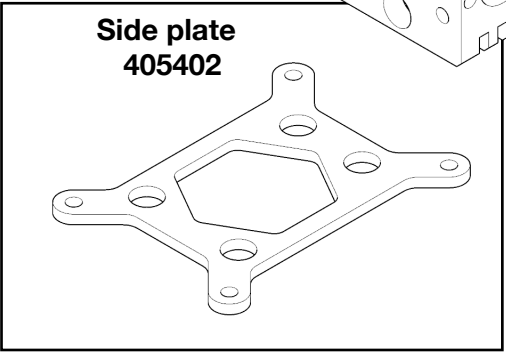
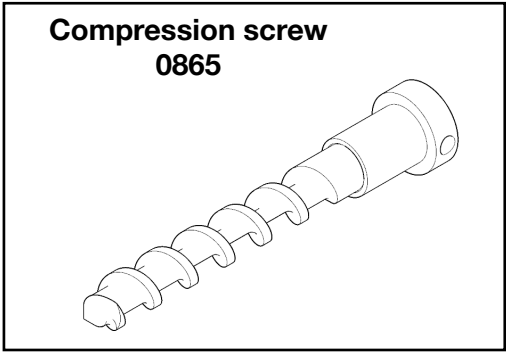
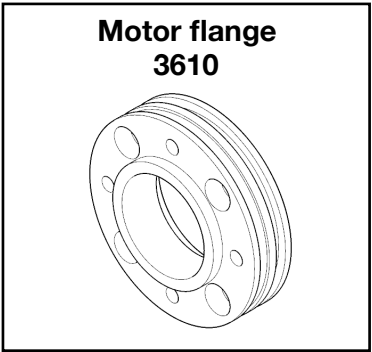
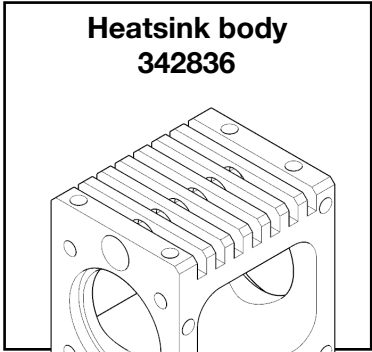
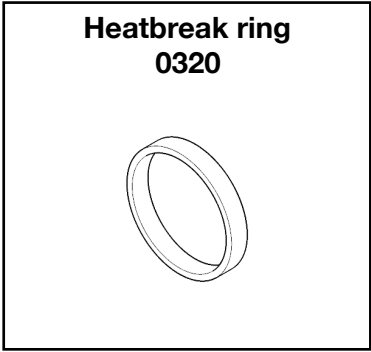
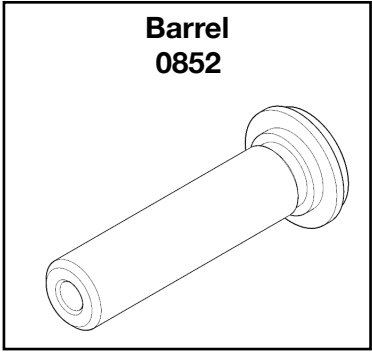
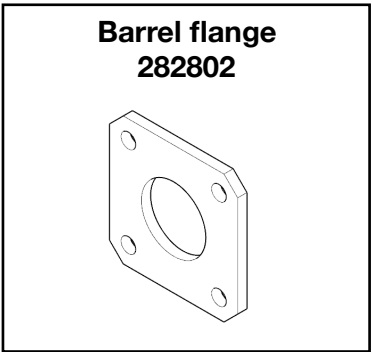
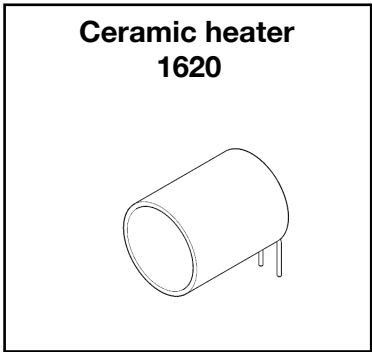
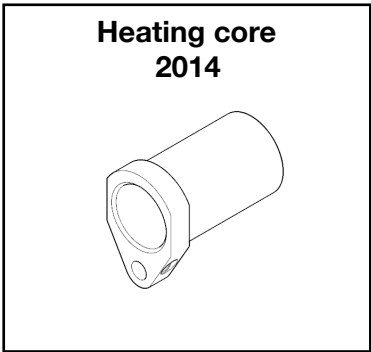
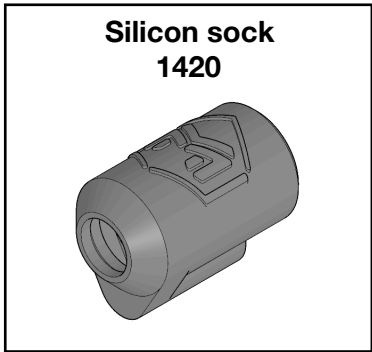

Standard parts

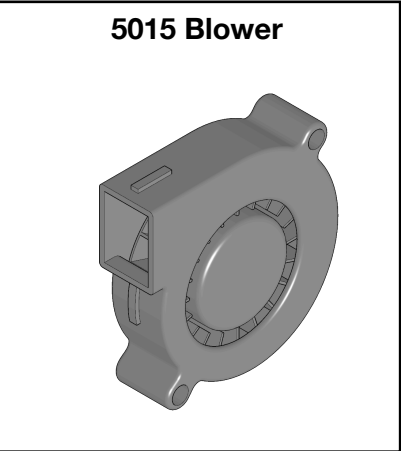
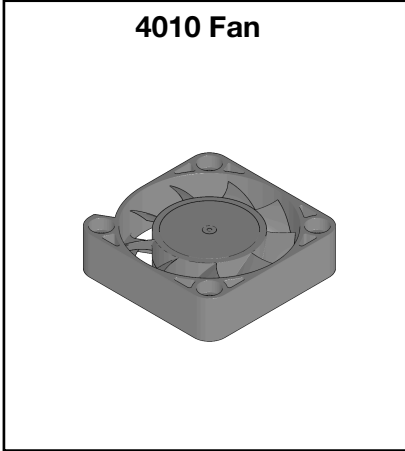
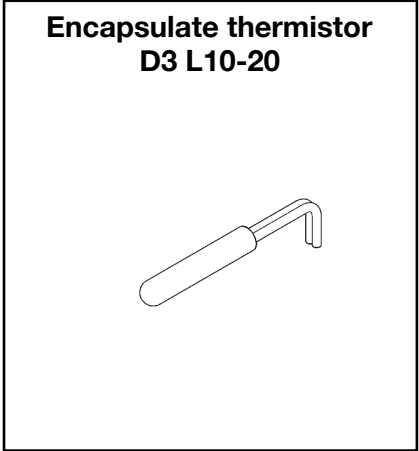
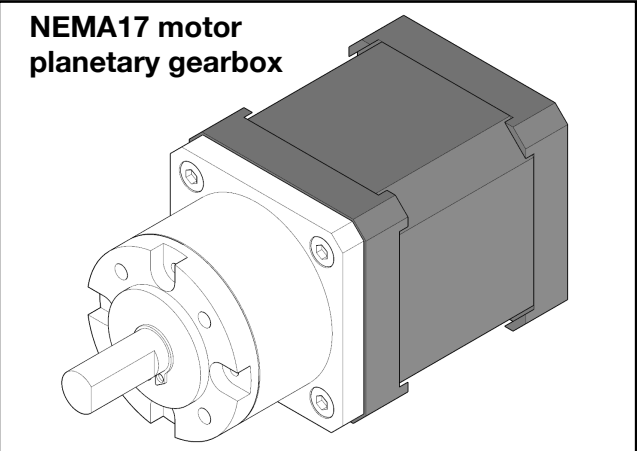
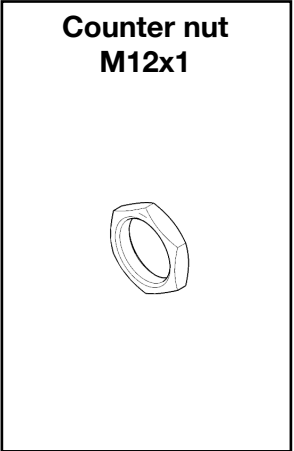
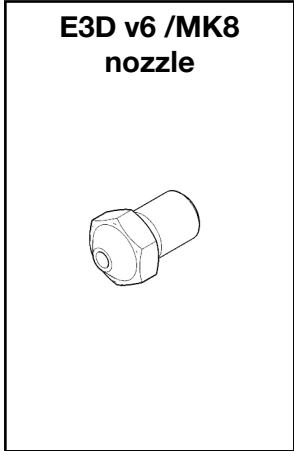

Exploded view

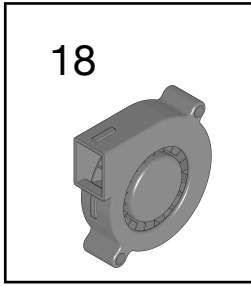
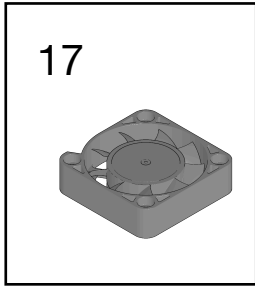

DIN / ISO	M	Q	Pos
DIN-913	M3x4	1	3-5
DIN-912	M3x8	4	7-10
DIN-912	M3x8	2	10-12
DIN-912	M3x8	4	12-13
DIN-913	M4x4	1	11-13
DIN-7991	M3x10	4	14-10
DIN-912	M3x6	5	15-16

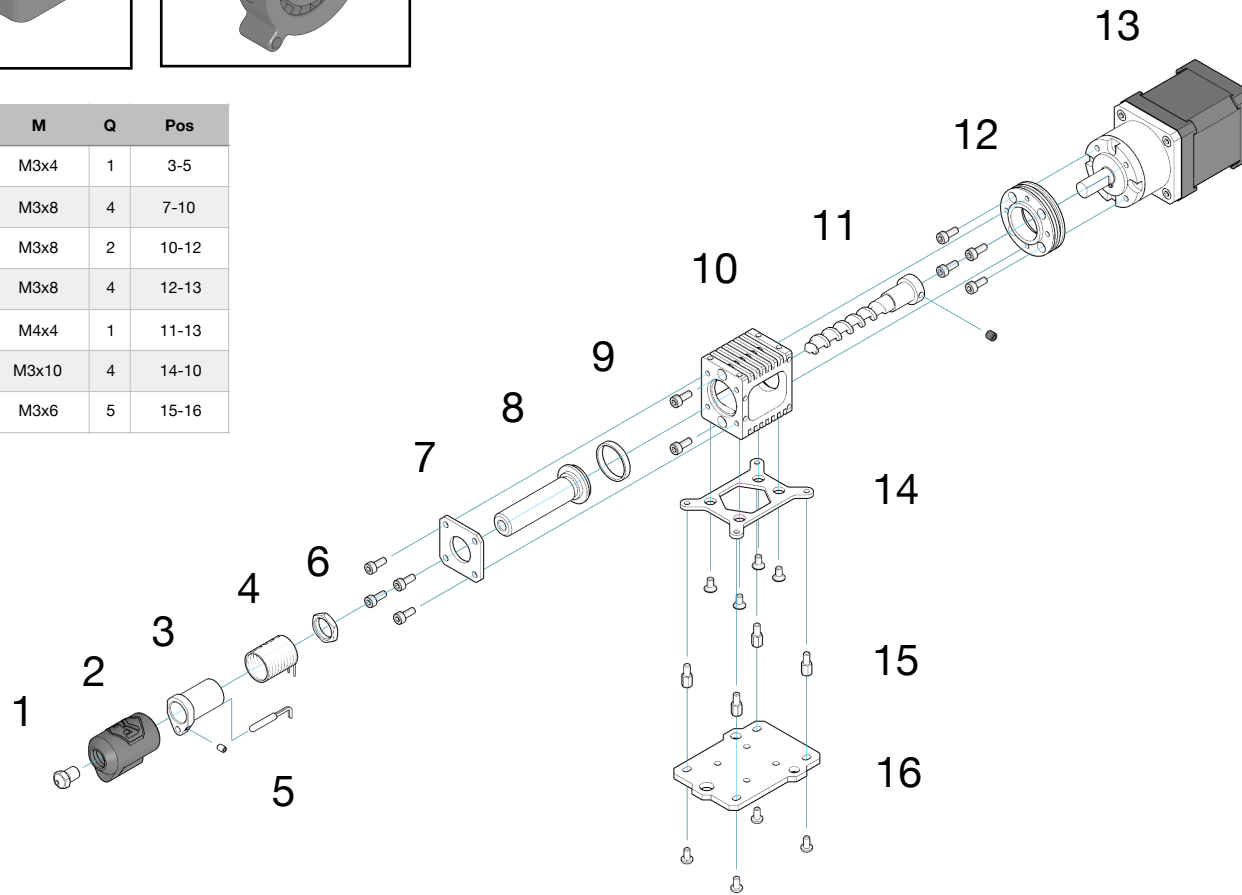

N°	NAME	REF
1	Nozzle	E3D v6 / Mk8
2	Silicon sock	1420
3	Heating core	2014
4	Ceramic heater	1620
5	Thermistor	NTC 100k
6	Counter nut	M12x1
7	Barrel flange	282802
8	Barrel	0852
9	Heatbreak ring	0320
10	Heatsink body	342836
11	Compression screw	0865
12	Motor flange	3610
13	Motor planetary gearbox	NEMA17-PG5
14	Side plate	405402
15	Male-female standoff	M3x6
16	Carriage plate	655003
17	Cooling Fan	4010
18	Layer fan	5015

V5 Pellet Extruder

IAMTECH

Extruder assembly

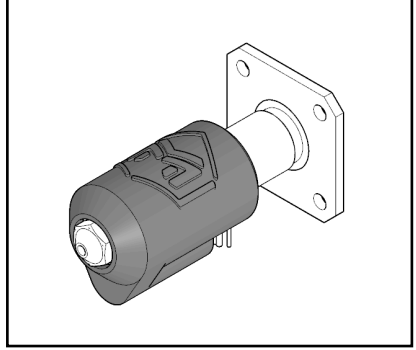
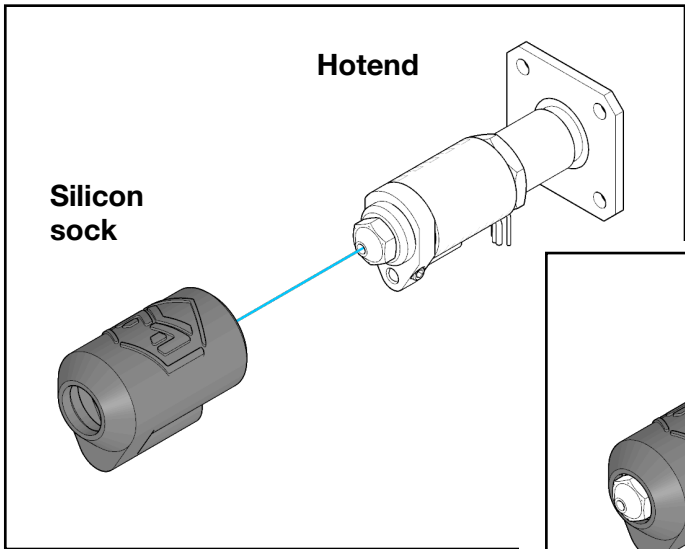
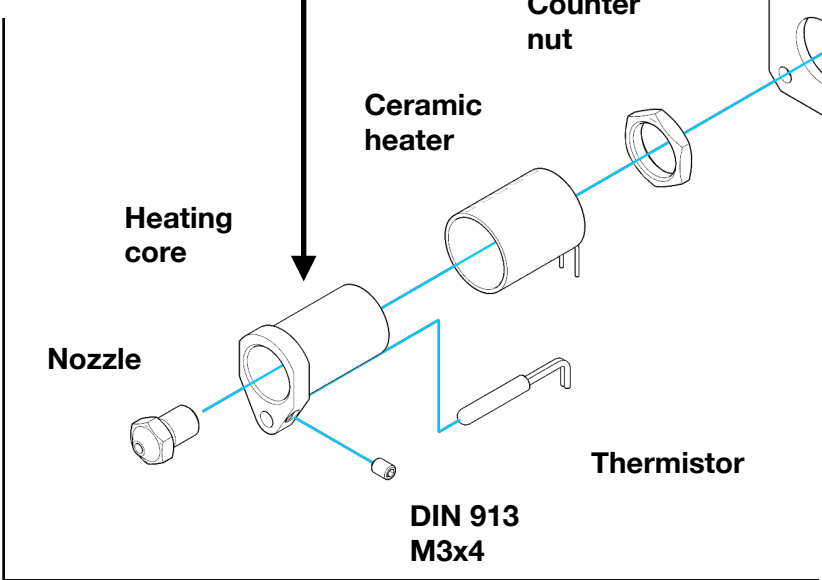
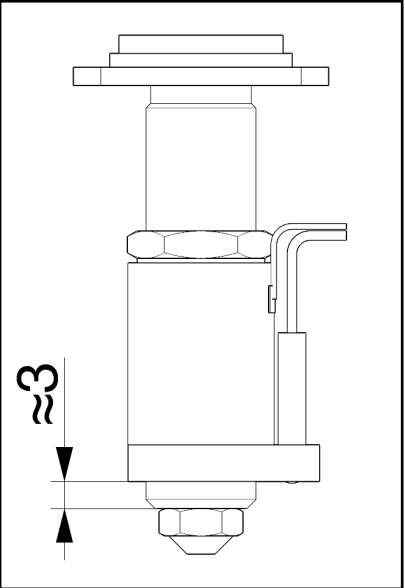
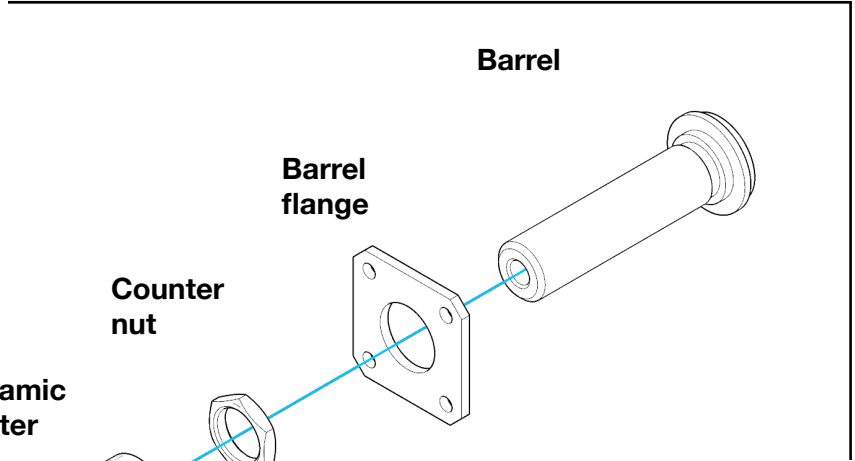
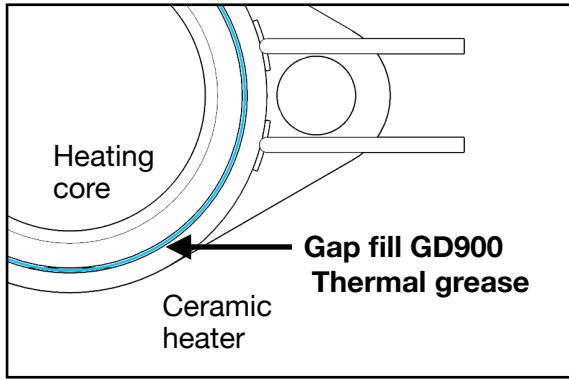

V5 Pellet Extruder

IAMTECH

Extruder assembly

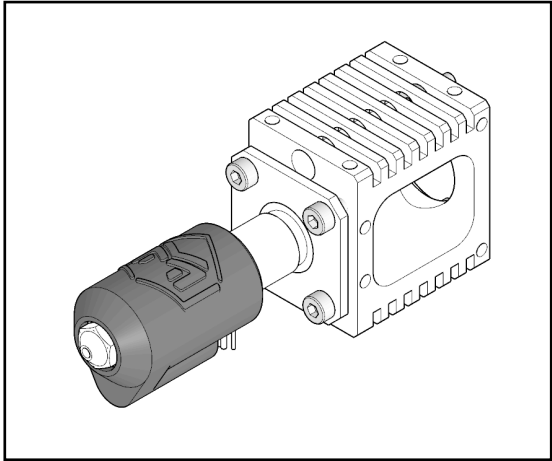
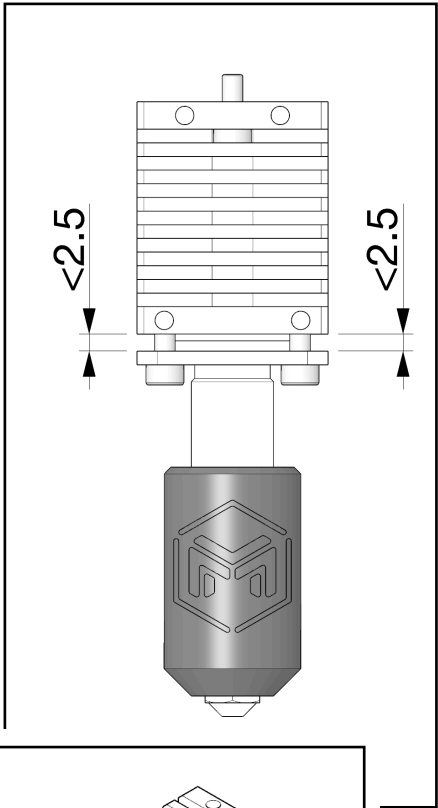
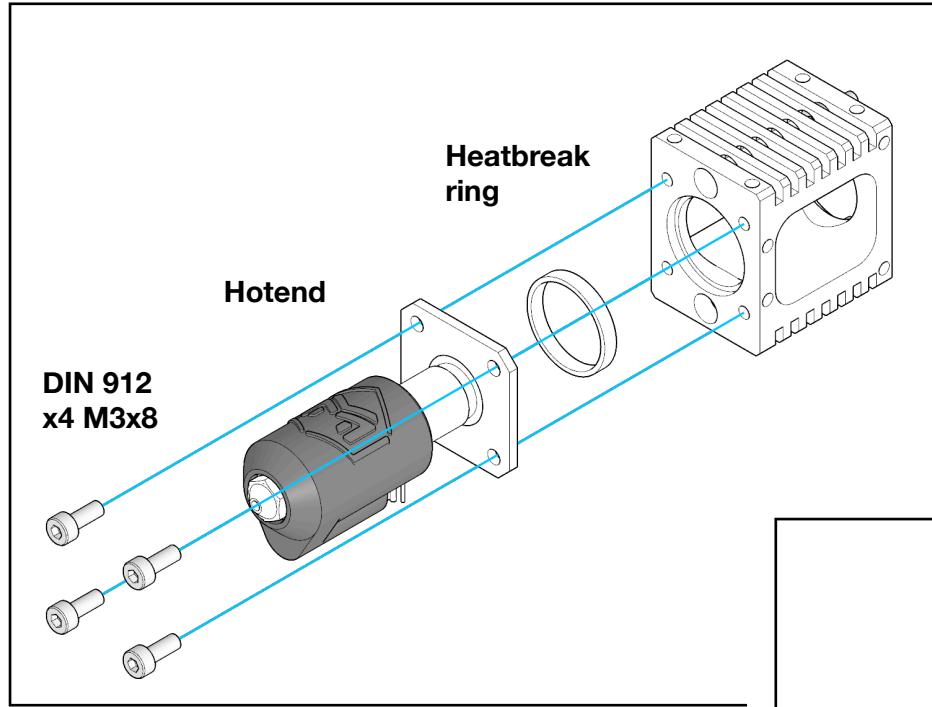
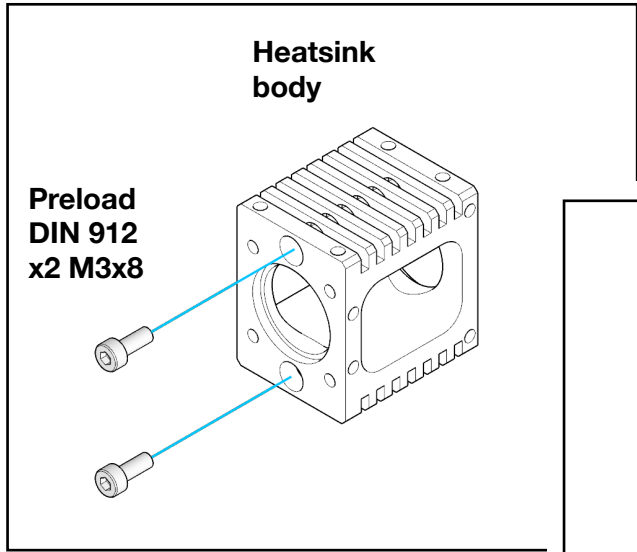

MAHOR·XYZ

Extruder assembly

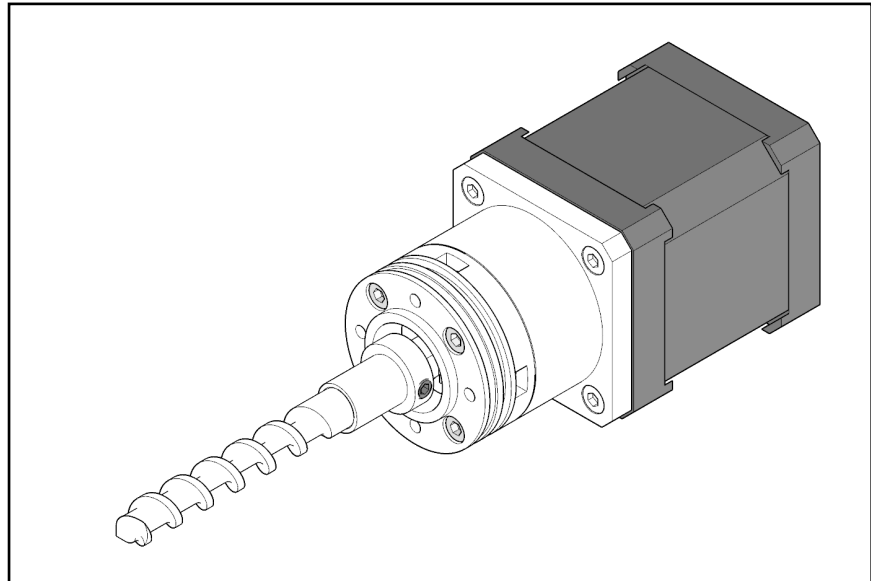
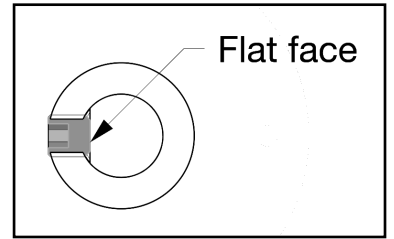
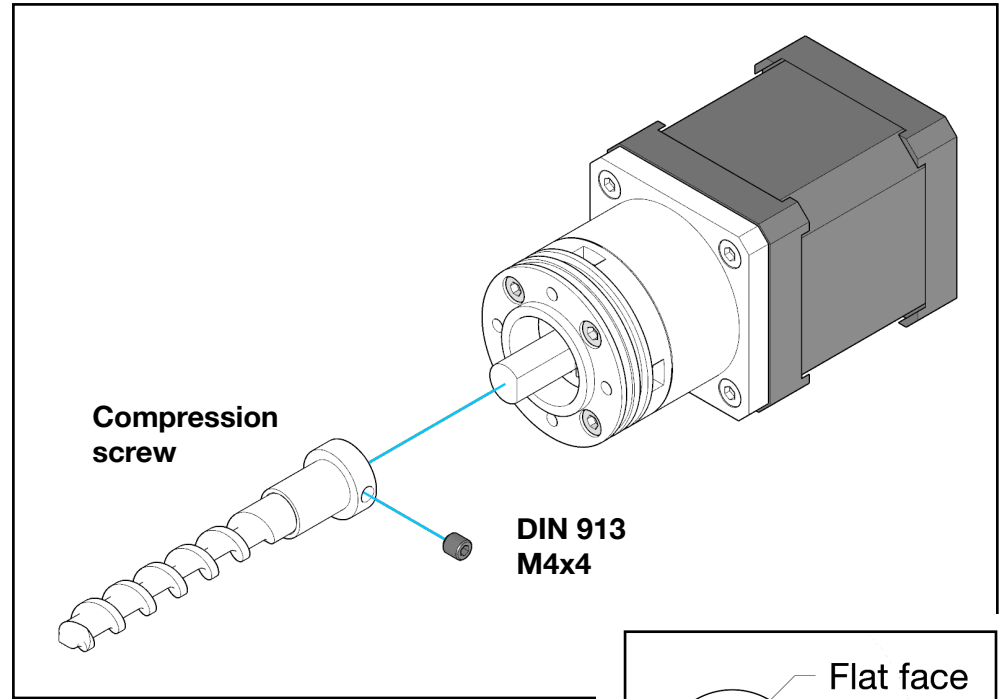
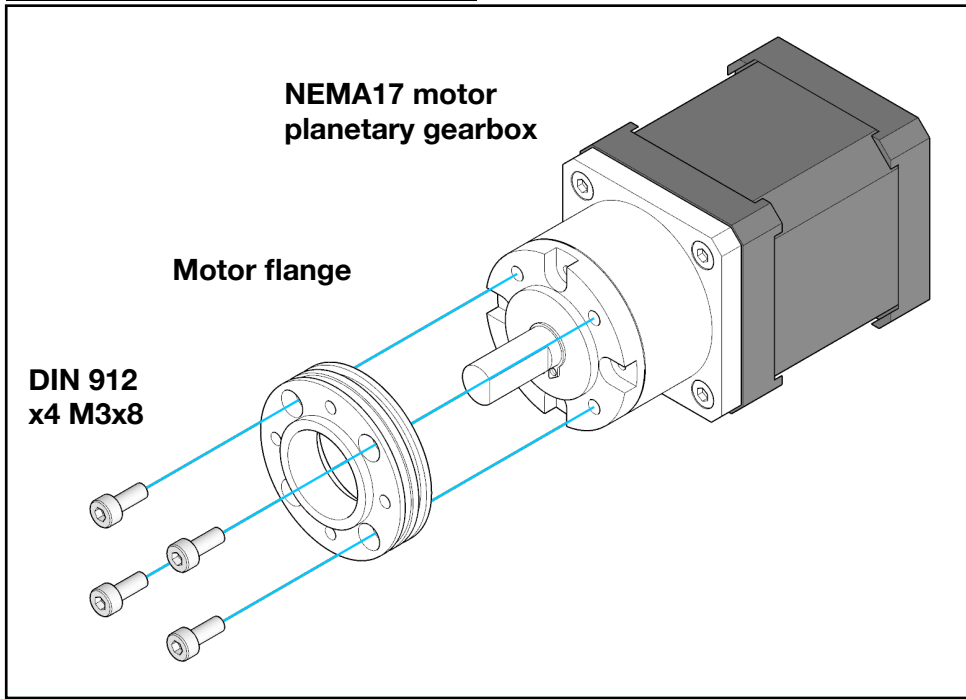

Extruder assembly

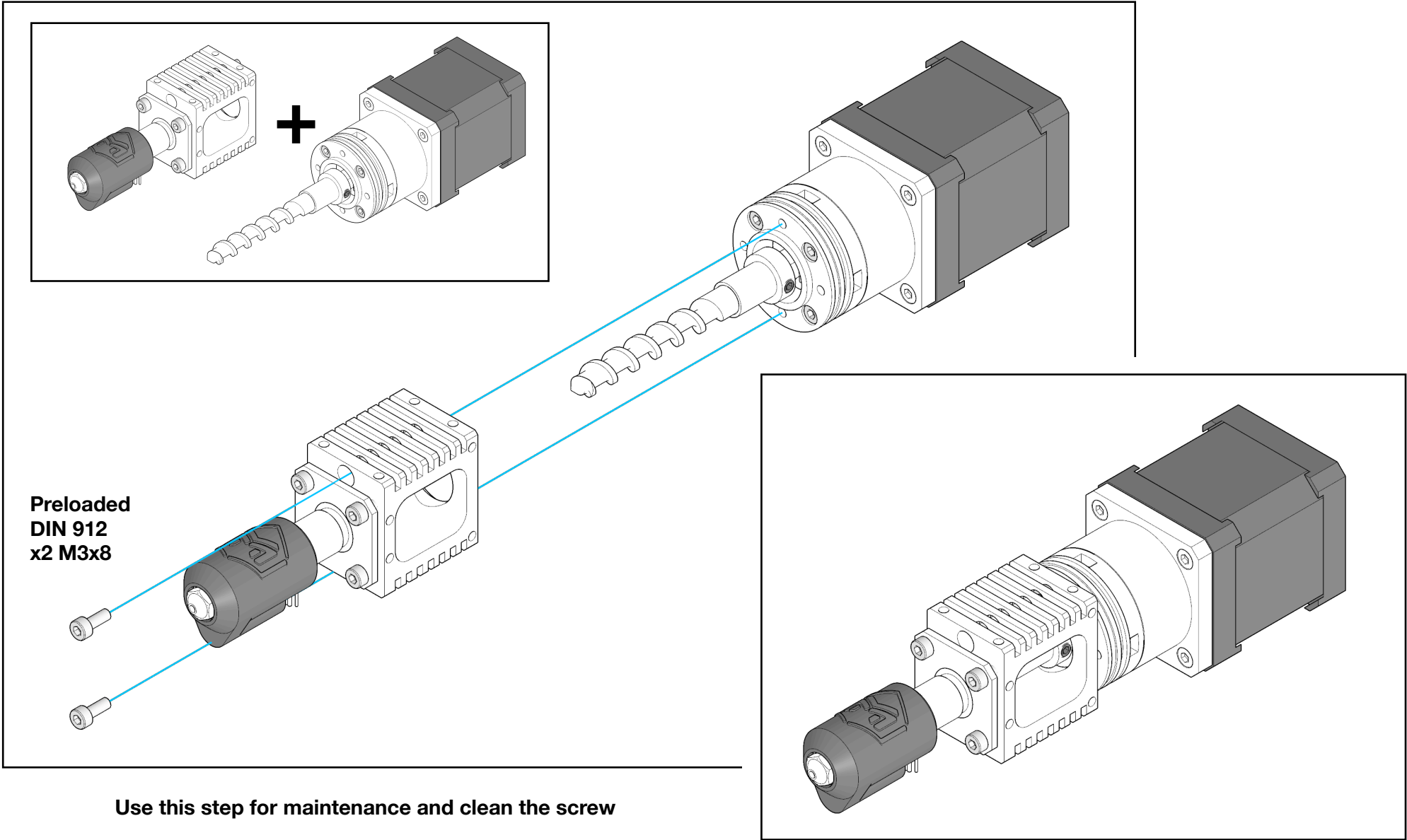

Extruder assembly

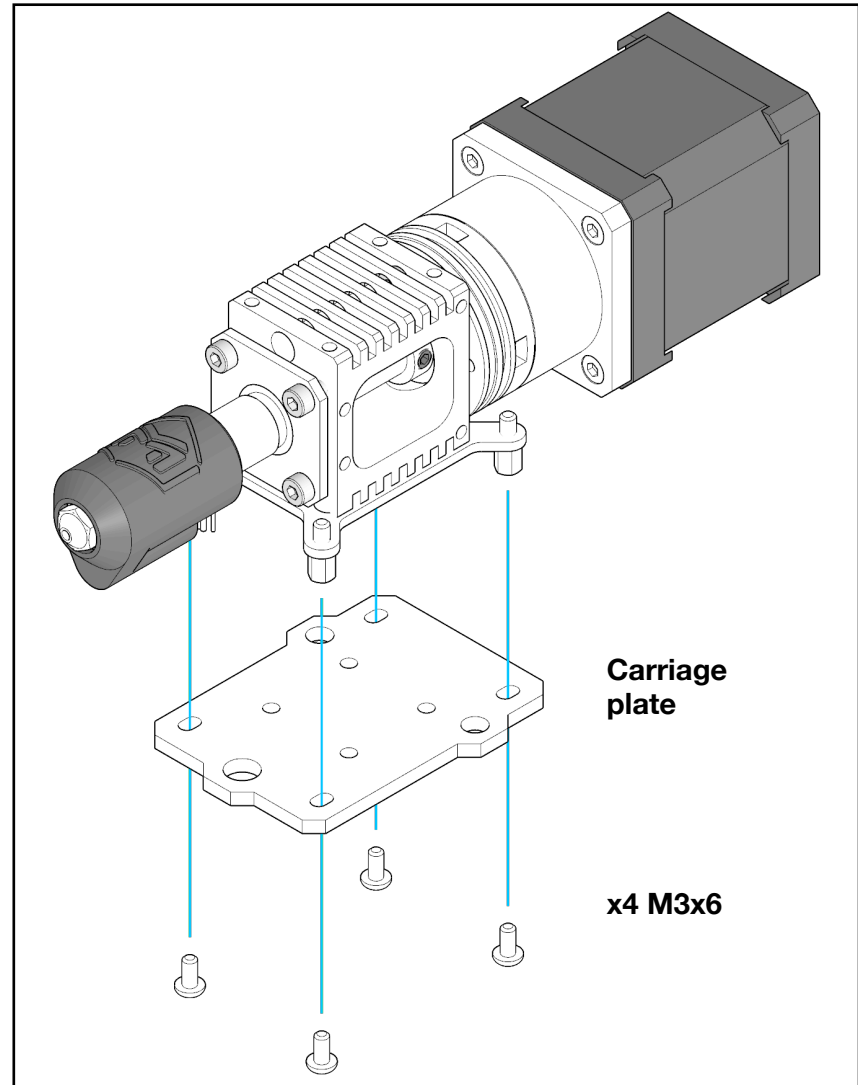
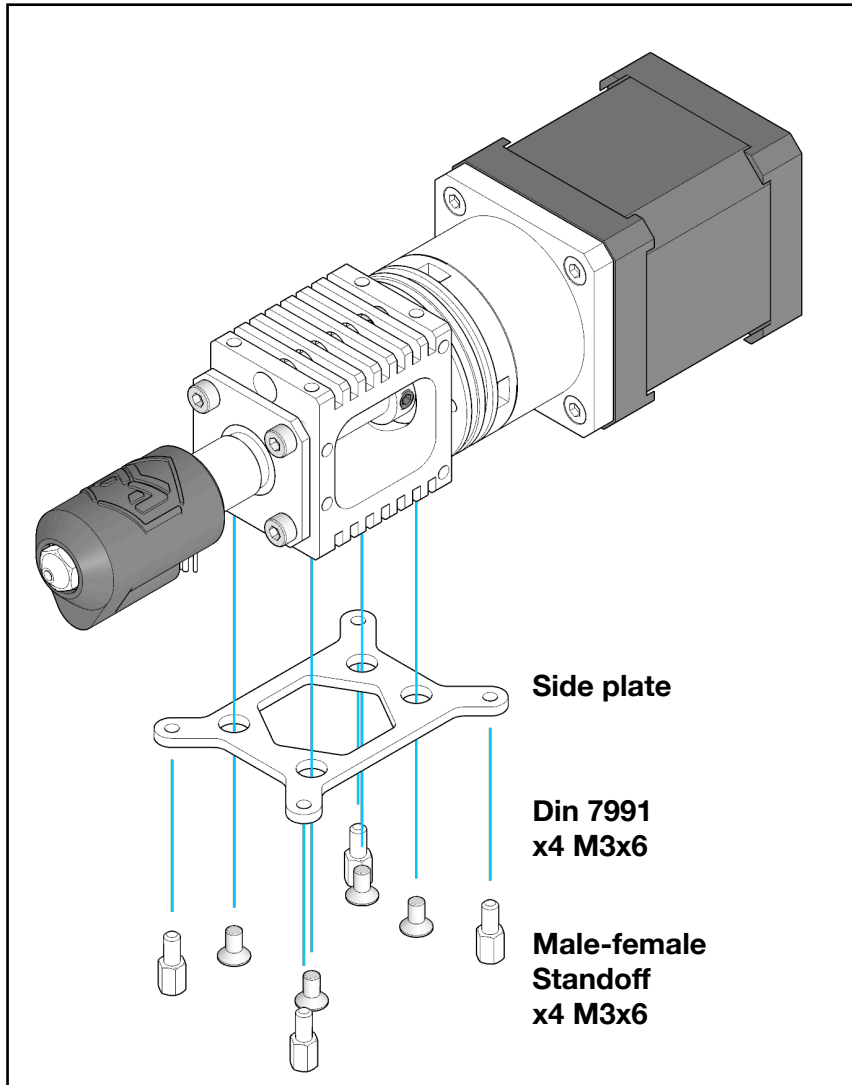

V5 Pellet Extruder

IAMTECH

PACK

4010 Fan

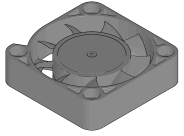

5015 Blower

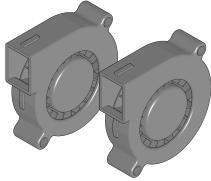

NTC 100K

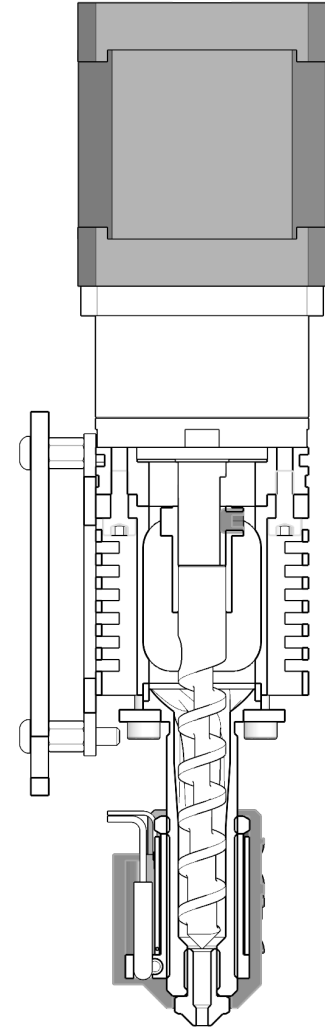
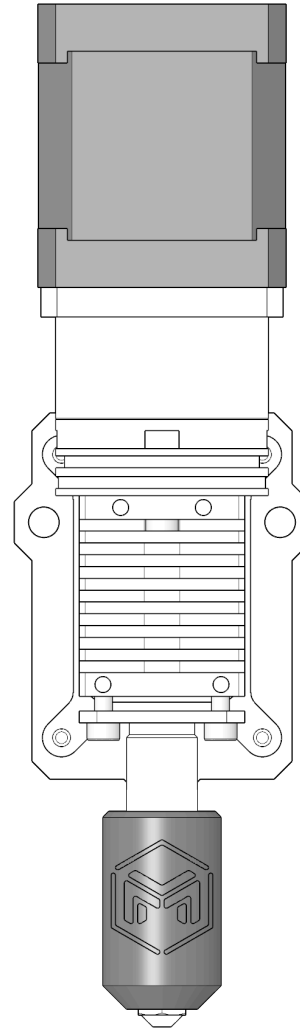
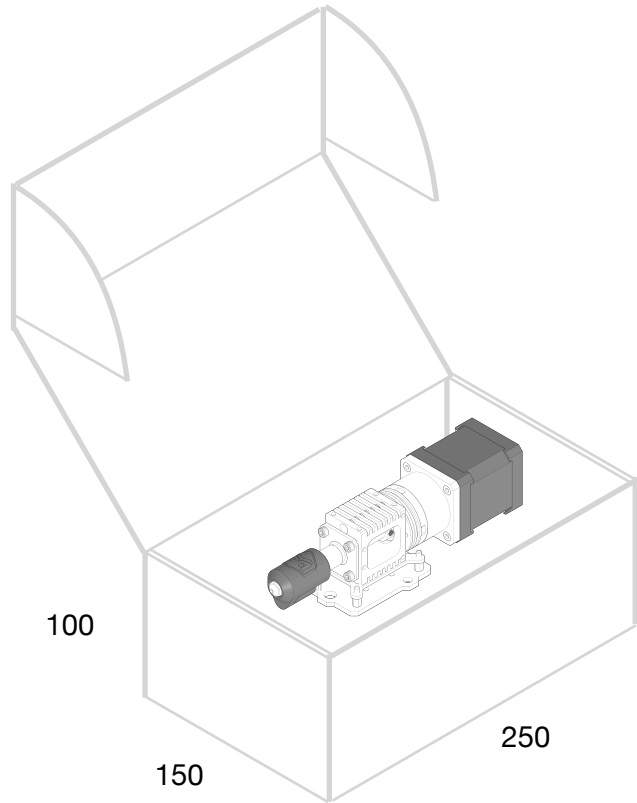
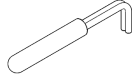

MAHOR·XYZ

Printer installation

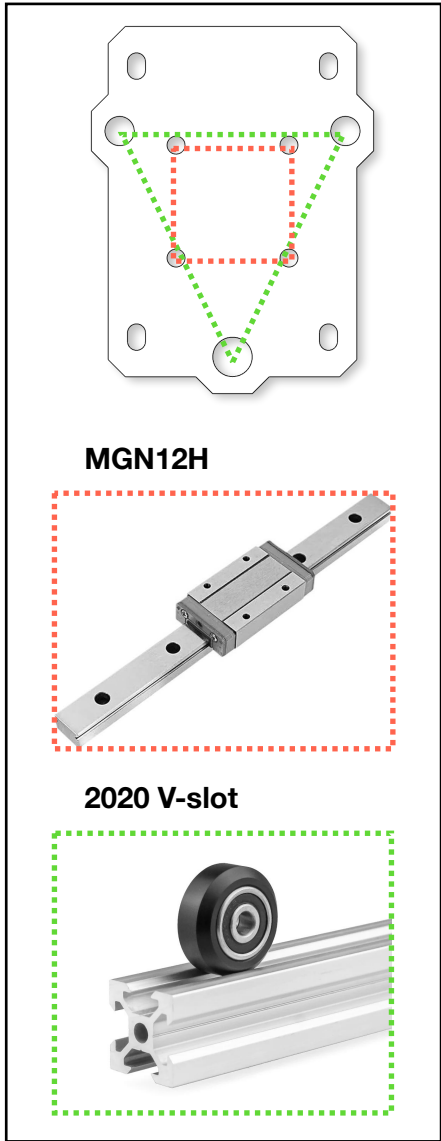

Clockwise CW rotation

TYPE OF CONNECTION (EXTERN)		MOTOR	
PIN NO	BIPOLAR	LEADS	WINDING
1	A+ —	BLK	A+
2	A- —	GRN	A-
3	B+ —	RED	B+
4	B- —	BLU	B-

FULL STEP 2 PHASE-Ex. WHEN FACING MOUNTING END (X)

STEP	A+	B+	A-	B-	CCW	CW
1	+	+	-	-	↓	↑
2	-	+	+	-	↓	↑
3	-	-	+	+	↓	↑
4	+	-	-	+	↓	↑

Ambient cooling

Glass transition (Tg)

Melting (Tm)

Links

<https://mahor.xyz/>

<https://mahor.xyz/downloads/>

<https://mahor.xyz/producto/feedstock-lite/>

